



FBM ALÜMİNYUM Pergola Systems, specially designed with inspiration from oak wood; with its advanced technology and functional features, it makes living spaces such as hotels, cafes, restaurants, residences, terraces, winter/summer gardens, shopping centers more comfortable and indispensable. Experience only the beauties of nature, not the negative aspects, by installing it together with guillotine, zip curtain and sliding glass systems.

DESIGN AND FUNCTIONALITY

- FBM ALÜMİNYUM Pergola Systems is an opening & closing system designed with specially designed fabrics, adapted on aluminum carriers.
- The pergola system engine using RTS technology works with a remote control and the movement can be stopped at any point thanks to the start-stop technology.
- The entire system or a single module can be operated with a remote control.
- With rain and wind sensors that can be added to the system, the system detects rain and storm conditions when it is on and turns off automatically.
- It creates a 24/7 usage area with LED lighting.
- The hidden part of the drainage system, which is integrated into both beams and columns, makes it possible to evacuate rain and water.

Düz/Oval Pergola

Flat / Oval Pergola

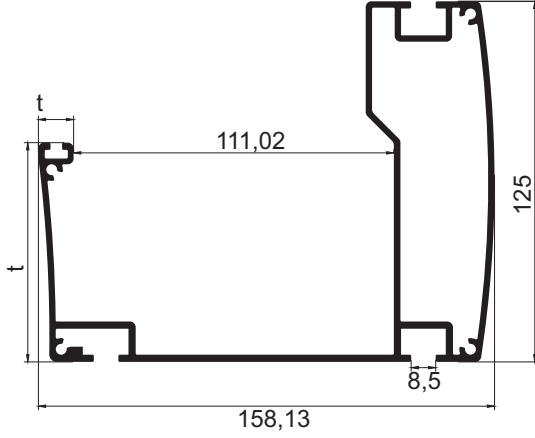

P-106 Orta Seri Oluk
3,916 kg/m

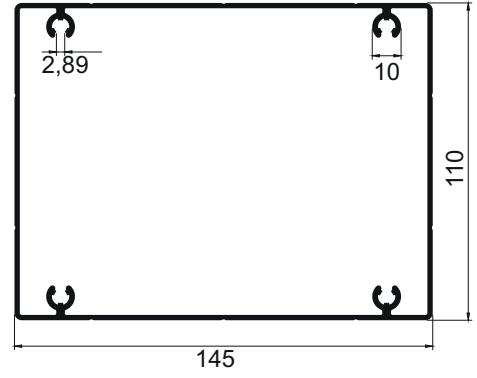

P-107 Ayak 100x145
3,440 kg/m

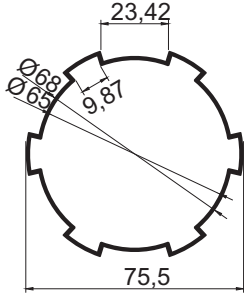

P-105 75'lik Boru
1,100 kg/m

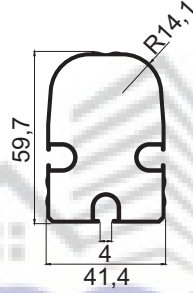

P-104 İnce Korniş
0,937 kg/m

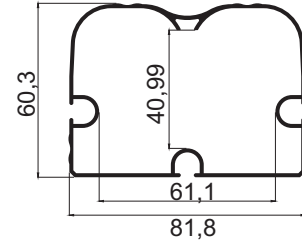

P-103 Kalın Korniş
1,280 kg/m

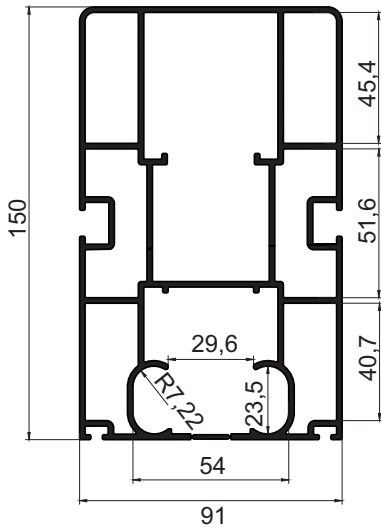

P-102 Orta Seri Ray
5,217 kg/m

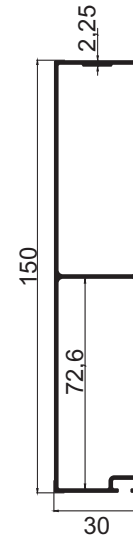

P-101 30x150 Kutu
1,711 kg/m

UYARI! Alüminyum profillerin, yukarıda belirtilen birim ağırlıkları yaklaşık olarak hesaplanmıştır. Gerçek birim ağırlıkları, teslimat sırasında yapılan tartım işlemi sonucuna göre hesaplanacaktır.
WARNING! Above mentioned aluminium profiles unit weights have been theoretically calculated. The actual unit weight will be calculated on delivery to put into the invoicing process.